



**Hillingdon**  
**Application to vary a premises licence**  
**Licensing Act 2003**

For help contact  
[licensing@hillingsdon.gov.uk](mailto:licensing@hillingsdon.gov.uk)  
Telephone: 01895 558170

\* required information

**Section 1 of 18**

You can save the form at any time and resume it later. You do not need to be logged in when you resume.

System reference

Not Currently In Use

This is the unique reference for this application generated by the system.

Your reference

You can put what you want here to help you track applications if you make lots of them. It is passed to the authority.

Are you an agent acting on behalf of the applicant?

- Yes  No

Put "no" if you are applying on your own behalf or on behalf of a business you own or work for.

**Applicant Details**

\* First name

Abdul

\* Family name

Ghaffar

\* E-mail

Main telephone number

Include country code.

Other telephone number

- Indicate here if you would prefer not to be contacted by telephone

Are you:

- Applying as a business or organisation, including as a sole trader  
 Applying as an individual

A sole trader is a business owned by one person without any special legal structure. Applying as an individual means you are applying so you can be employed, or for some other personal reason, such as following a hobby.

**Applicant Business**

Is your business registered in the UK with Companies House?

- Yes  No

Note: completing the Applicant Business section is optional in this form.

Registration number

03597480

Business name

Oregano Limited

If your business is registered, use its registered name.

VAT number

- 725973991

Put "none" if you are not registered for VAT.

Legal status

Private Limited Company

*Continued from previous page...*

Your position in the business

Home country

The country where the headquarters of your business is located.

**Registered Address**

Address registered with Companies House.

Building number or name

Street

District

City or town

County or administrative area

Postcode

Country

**Section 2 of 18**

**APPLICATION DETAILS**

**This application cannot be used to vary the licence so as to extend the period for which the licence has effect or to vary substantially the premises to which it relates. If you wish to make that type of change to the premises licence, you should make a new premises licence application under section 17 of the Licensing Act 2003.**

I/we, as named in section 1, being the premises licence holder, apply to vary a premises licence under section 34 of the Licensing Act 2003 for the premises described in section 2 below.

\* Premises Licence Number

Are you able to provide a postal address, OS map reference or description of the premises?

- Address     OS map reference     Description

**Postal Address Of Premises**

Building number or name

Street

District

City or town

County or administrative area

Postcode

Country

**Premises Contact Details**

Telephone number

Continued from previous page...

Non-domestic rateable value of premises (£)

30,500

### Section 3 of 18

#### VARIATION

Do you want the proposed variation to have effect as soon as possible?

Yes  No

Do you want the proposed variation to have effect in relation to the introduction of the late night levy?

Yes  No

You do not have to pay a fee if the only purpose of the variation for which you are applying is to avoid becoming liable to the late night levy.

If your proposed variation would mean that 5,000 or more people are expected to attend the premises at any one time, state the number expected to attend

#### Describe Briefly The Nature Of The Proposed Variation

Describe the premises. For example the type of premises, its general situation and layout and any other information which could be relevant to the licensing objectives. Where your application includes off-supplies of alcohol and you intend to provide a place for consumption of these off-supplies, you must include a description of where the place will be and its proximity to the premises.

We are changing Il Basilico to a cafe/takeaway which will also sell convenience, grocery and alcoholic items (beer, wine and spirits). As typical of a normal convenience store and in line with Sovereign Food & Wine (625 Sipson Road) which we have now vacated, we would like to open from 0600 7 days a week and if anyone wants to buy alcohol before our current licensing hours of 1000, we would like to accommodate them. We would also like to change the name of Il Basilico to Sovereign Food & Wine and have the licensing hours in line with those.

### Section 4 of 18

#### PROVISION OF PLAYS

[See guidance on regulated entertainment](#)

Will the schedule to provide plays be subject to change if this application to vary is successful?

Yes  No

### Section 5 of 18

#### PROVISION OF FILMS

[See guidance on regulated entertainment](#)

Will the schedule to provide films be subject to change if this application to vary is successful?

Yes  No

### Section 6 of 18

#### PROVISION OF INDOOR SPORTING EVENTS

*Continued from previous page...*

[See guidance on regulated entertainment](#)

Will the schedule to provide indoor sporting events be subject to change if this application to vary is successful?

- Yes  No

### Section 7 of 18

#### PROVISION OF BOXING OR WRESTLING ENTERTAINMENTS

[See guidance on regulated entertainment](#)

Will the schedule to provide boxing or wrestling entertainments be subject to change if this application to vary is successful?

- Yes  No

### Section 8 of 18

#### PROVISION OF LIVE MUSIC

[See guidance on regulated entertainment](#)

Will the schedule to provide live music be subject to change if this application to vary is successful?

- Yes  No

### Section 9 of 18

#### PROVISION OF RECORDED MUSIC

[See guidance on regulated entertainment](#)

Will the schedule to provide recorded music be subject to change if this application to vary is successful?

- Yes  No

### Section 10 of 18

#### PROVISION OF PERFORMANCES OF DANCE

[See guidance on regulated entertainment](#)

Will the schedule to provide performances of dance be subject to change if this application to vary is successful?

- Yes  No

### Section 11 of 18

#### PROVISION OF ANYTHING OF A SIMILAR DESCRIPTION TO LIVE MUSIC, RECORDED MUSIC OR PERFORMANCES OF DANCE

[See guidance on regulated entertainment](#)

Will the schedule to provide anything similar to live music, recorded music or performances of dance be subject to change if this application to vary is successful?

- Yes  No

### Section 12 of 18

#### PROVISION OF LATE NIGHT REFRESHMENT

*Continued from previous page...*

Will the schedule to provide late night refreshment be subject to change if this application to vary is successful?

- Yes  No

**Section 13 of 18**

**SUPPLY OF ALCOHOL**

Will the schedule to supply alcohol be subject to change if this application to vary is successful?

- Yes  No

**Standard Days And Timings**

MONDAY

Start

End

Start

End

Provide timings in 24 hour clock (e.g., 16:00) and only give details for the days of the week when you intend the premises to be used for the activity.

TUESDAY

Start

End

Start

End

WEDNESDAY

Start

End

Start

End

THURSDAY

Start

End

Start

End

FRIDAY

Start

End

Start

End

SATURDAY

Start

End

Start

End

SUNDAY

Start

End

Start

End

**Continued from previous page...**

Will the sale of alcohol be for consumption?

- On the premises       Off the premises       Both

If the sale of alcohol is for consumption on the premises select on, if the sale of alcohol is for consumption away from the premises select off. If the sale of alcohol is for consumption on the premises and away from the premises select both.

State any seasonal variations.

For example (but not exclusively) where the activity will occur on additional days during the summer months.

None

Non-standard timings. Where the premises will be used for the supply of alcohol at different times from those listed above, list below.

For example (but not exclusively), where you wish the activity to go on longer on a particular day e.g. Christmas Eve.

All public holidays from 0600 to 2300 so this would not run longer, just earlier. I believe the provision in the current license for New Year's Eve runs to New Year's Day.

**Section 14 of 18**

**ADULT ENTERTAINMENT**

Highlight any adult entertainment or services, activities, or other entertainment or matters ancillary to the use of the premises that may give rise to concern in respect of children.

Provide information about anything intended to occur at the premises or ancillary to the use of the premises which may give rise to concern in respect of children, regardless of whether you intend children to have access to the premises, for example (but not exclusively) nudity or semi-nudity, films for restricted age groups etc gambling machines etc.

None

**Section 15 of 18**

**HOURS PREMISES ARE OPEN TO THE PUBLIC**

**Standard Days And Timings**

MONDAY

Start

End

Start

End

Provide timings in 24 hour clock (e.g., 16:00) and only give details for the days of the week when you intend the premises to be used for the activity.

TUESDAY

Start

End

Start

End

*Continued from previous page...*

WEDNESDAY

Start  End

Start  End

THURSDAY

Start  End

Start  End

FRIDAY

Start  End

Start  End

SATURDAY

Start  End

Start  End

SUNDAY

Start  End

Start  End

State any seasonal variations.

For example (but not exclusively) where the activity will occur on additional days during the summer months.

Non standard timings. Where you intend to use the premises to be open to the members and guests at different times from those listed above, list below.

For example (but not exclusively), where you wish the activity to go on longer on a particular day e.g. Christmas Eve.

All public holidays from 0600 to 2300 so this would not run longer, just earlier. I believe the provision in the current license for New Year's Eve runs to New Year's Day.

Identify those conditions currently imposed on the licence which you believe could be removed as a consequence of the proposed variation you are seeking.

I believe these would be for the hours for public holidays

I have enclosed the premises licence

**Continued from previous page...**

I have enclosed the relevant part of the premises licence

Reasons why I have failed to enclose the premises licence or relevant part of premises licence.

**Section 16 of 18**

**LICENSING OBJECTIVES**

Describe the steps you intend to take to promote the four licensing objectives:

a) General – all four licensing objectives (b,c,d,e)

List here steps you will take to promote all four licensing objectives together.

The premises license holder shall be on the premises and staff should also know how to promote all four licensing objectives.

b) The prevention of crime and disorder

Our cctv installed shall be in good working order and used at all times. The footage from the cctv shall be kept in order to provide this to the police or other authority that requires it.  
Any criminal incident shall be logged and reported to Hillingdon police.  
External lighting and fascia shall be kept on from before dusk until the premises close.

c) Public safety

The external area of the premises shall be kept free of litter and obstruction.  
This shall also apply within the premises and any cleaning or maintenance that could affect members of the public whilst in the premises shall be signed according to health and safety regulations.  
All fire safety equipment shall be checked and maintained by an approved contractor.  
All first aid equipment shall be present in case of any accidents.  
All entry and exit points within the premises shall be kept free of obstruction.  
The number of people within the premises should be monitored to be kept within a safe limit.

d) The prevention of public nuisance

Any customer drinking on the premises shall be monitored and not allowed to drink to excess.  
As we are in a non residential complex, the risk to public nuisance in the immediate vicinity is less than usual but customers should still be monitored when drinking on the premises so when they leave they do not cause a public nuisance.  
There is only a small minority of customers, perhaps 5% who will consume alcohol on the premises, and this is only in extreme moderation.  
We do not hold major functions on the premises so noise nuisance will not apply in the traditional sense.

e) The protection of children from harm

Under no circumstances whatsoever, is alcohol allowed to be sold to those under the legal age. Any staff member in any



*Continued from previous page...*

doubt whatsoever should ask for original proof their age. Any person refused to be sold alcohol should be logged.

## Section 17 of 18

### NOTES ON REGULATED ENTERTAINMENT

In terms of specific **regulated entertainments** please note that:

- Plays: no licence is required for performances between 08:00 and 23.00 on any day, provided that the audience does not exceed 500.
- Films: no licence is required for 'not-for-profit' film exhibition held in community premises between 08.00 and 23.00 on any day provided that the audience does not exceed 500 and the organiser (a) gets consent to the screening from a person who is responsible for the premises; and (b) ensures that each such screening abides by age classification ratings.
- Indoor sporting events: no licence is required for performances between 08.00 and 23.00 on any day, provided that the audience does not exceed 1000.
- Boxing or Wrestling Entertainment: no licence is required for a contest, exhibition or display of Greco-Roman wrestling, or freestyle wrestling between 08.00 and 23.00 on any day, provided that the audience does not exceed 1000. Combined fighting sports – defined as a contest, exhibition or display which combines boxing or wrestling with one or more martial arts – are licensable as a boxing or wrestling entertainment rather than an indoor sporting event.
- Live music: no licence permission is required for:
  - o a performance of unamplified live music between 08.00 and 23.00 on any day, on any premises.
  - o a performance of amplified live music between 08.00 and 23.00 on any day on premises authorised to sell alcohol for consumption on those premises, provided that the audience does not exceed 500.
  - o a performance of amplified live music between 08.00 and 23.00 on any day, in a workplace that is not licensed to sell alcohol on those premises, provided that the audience does not exceed 500.
  - o a performance of amplified live music between 08.00 and 23.00 on any day, in a church hall, village hall, community hall, or other similar community premises, that is not licensed by a premises licence to sell alcohol, provided that (a) the audience does not exceed 500, and (b) the organiser gets consent for the performance from a person who is responsible for the premises.
  - o a performance of amplified live music between 08.00 and 23.00 on any day, at the non-residential premises of (i) a local authority, or (ii) a school, or (iii) a hospital, provided that (a) the audience does not exceed 500, and (b) the organiser gets consent for the performance on the relevant premises from: (i) the local authority concerned, or (ii) the school or (iii) the health care provider for the hospital.
- Recorded Music: no licence permission is required for:
  - o any playing of recorded music between 08.00 and 23.00 on any day on premises authorised to sell alcohol for consumption on those premises, provided that the audience does not exceed 500.
  - o any playing of recorded music between 08.00 and 23.00 on any day, in a church hall, village hall, community hall, or other similar community premises, that is not licensed by a premises licence to sell alcohol, provided that (a) the audience does not exceed 500, and (b) the organiser gets consent for the performance from a person who is responsible for the premises.
  - o any playing of recorded music between 08.00 and 23.00 on any day, at the non-residential premises of (i) a local authority, or (ii) a school, or (iii) a hospital, provided that (a) the audience does not exceed 500, and (b) the organiser gets consent for the performance on the relevant premises from: (i) the local authority concerned, or (ii) the school proprietor or (iii) the health care provider for the hospital.

**Continued from previous page...**

- Dance: no licence is required for performances between 08.00 and 23.00 on any day, provided that the audience does not exceed 500. However, a performance which amounts to adult entertainment remains licensable.
- Cross activity exemptions: no licence is required between 08.00 and 23.00 on any day, with no limit on audience size for:
  - o any entertainment taking place on the premises of the local authority where the entertainment is provided by or on behalf of the local authority;
  - o any entertainment taking place on the hospital premises of the health care provider where the entertainment is provided by or on behalf of the health care provider;
  - o any entertainment taking place on the premises of the school where the entertainment is provided by or on behalf of the school proprietor; and
  - o any entertainment (excluding films and a boxing or wrestling entertainment) taking place at a travelling circus, provided that (a) it takes place within a moveable structure that accommodates the audience, and (b) that the travelling circus has not been located on the same site for more than 28 consecutive days.

**Section 18 of 18**

**PAYMENT DETAILS**

This fee must be paid to the authority. If you complete the application online, you must pay it by debit or credit card. Premises' licence fees are determined by the non-domestic rateable value of the premises. To find out a premises' non-domestic rateable value, go to the Valuation Office Agency website at [http://www.voa.gov.uk/business\\_rates/index.htm](http://www.voa.gov.uk/business_rates/index.htm).

For full details of our fees, refer to the licensing webpage: <http://www.hillingdon.gov.uk/licensing> and follow the 'Fees for all applications' link on the right-hand side of the page.

\* Fee amount (£)

**DECLARATION**

\* I/we understand it is an offence, liable on conviction to a fine up to level 5 on the standard scale, under section 158 of the licensing act 2003, to make a false statement in or in connection with this application.

Ticking this box indicates you have read and understood the above declaration

This section should be completed by the applicant, unless you answered "Yes" to the question "Are you an agent acting on behalf of the applicant?"

\* Full name

\* Capacity

\* Date  /  /   
dd mm yyyy

Once you're finished you need to do the following:

1. Save this form to your computer by clicking file/save as...
2. Go back to <https://www.gov.uk/apply-for-a-licence/premises-licence/hillingdon/change-1> to upload this file and continue with your application.

Don't forget to make sure you have all your supporting documentation to hand.



**IT IS AN OFFENCE, UNDER SECTION 158 OF THE LICENSING ACT 2003, TO MAKE A FALSE STATEMENT IN OR IN CONNECTION WITH THIS APPLICATION. THOSE WHO MAKE A FALSE STATEMENT MAY BE LIABLE ON SUMMARY CONVICTION TO A FINE OF ANY AMOUNT.**

**OFFICE USE ONLY**

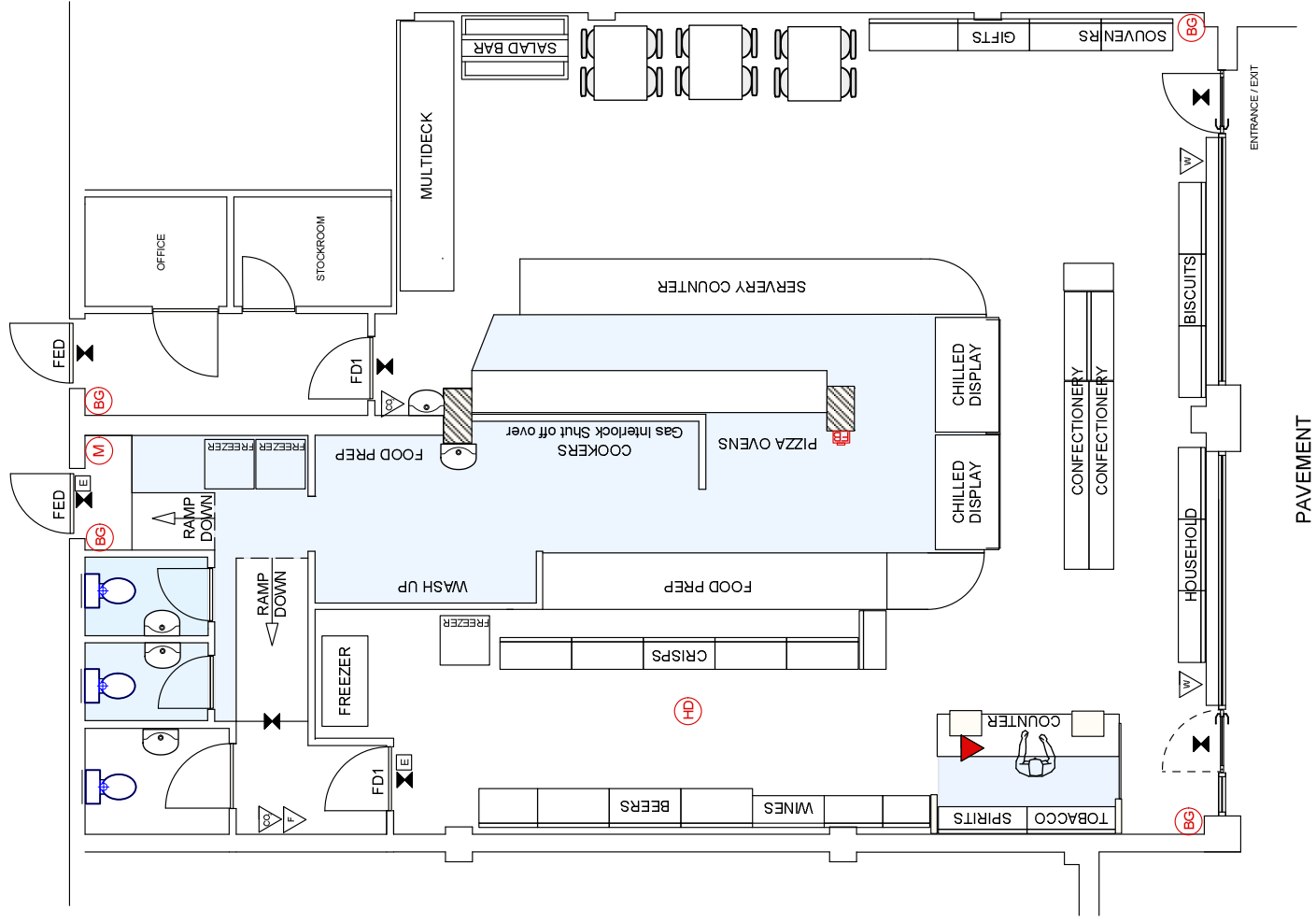
Applicant reference number	<input type="text"/>
Fee paid	<input type="text"/>
Payment provider reference	<input type="text"/>
ELMS Payment Reference	<input type="text"/>
Payment status	<input type="text"/>
Payment authorisation code	<input type="text"/>
Payment authorisation date	<input type="text"/>
Date and time submitted	<input type="text"/>
Approval deadline	<input type="text"/>
Error message	<input type="text"/>
Is Digitally signed	<input type="checkbox"/>



**SYMBOL** **DETAIL**

-  Emergency Light - ceiling mounted
-  Emergency Exit Sign
-  Portable Fire Extinguisher - Foam
-  Portable Fire Extinguisher - Carbon Dioxide
-  Portable Fire Extinguisher - Water
-  Heat Detector - ceiling mounted
-  Break Glass
-  Mains Electricity - Distribution Panel
- FD1 Internal Fire Door - fittings free and with wired vision panel
- FED External Fire Door - thumbturn operation
-  Pay Counter for all sales - including alcohol and tobacco products

Note: Fire Alarms and sensors are maintained and operated by the Landlord  
Refer to block plan for unit location

**SOVEREIGN FOOD AND WINE 627 SIPSON ROAD SIPSON WEST DRAYTON UB7 0JE**

Drawing no 2765.01 Plan Scale: 1-100 @ A3 Date: 24 May 2024



Salepoint Ltd  
Vista Centre  
Hounslow TW4 6JQ  
T: 020 85773080  
e: info@salepoint.co.uk

LEASE PLAN

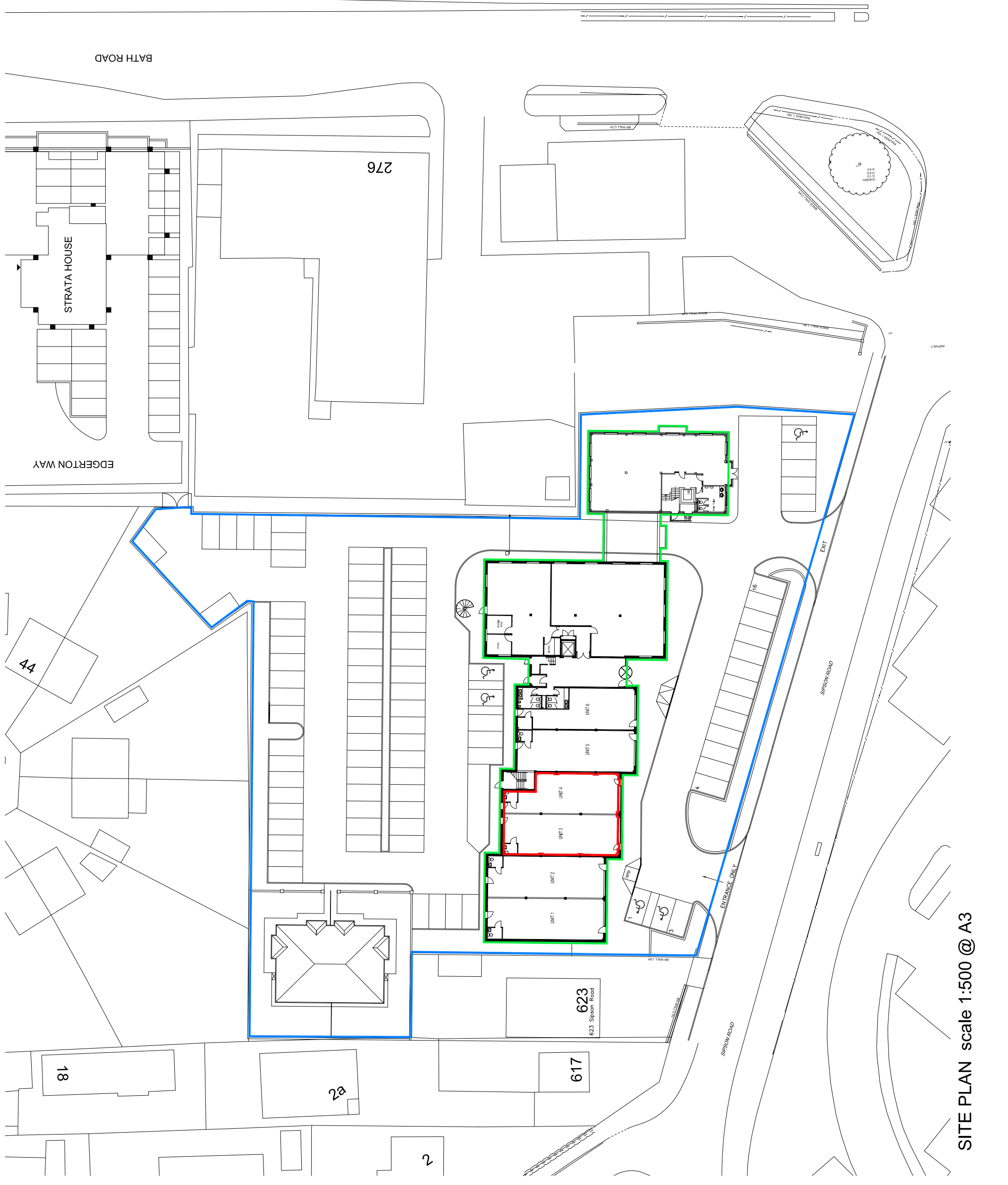
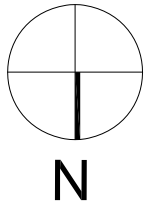

ORBIT DEVELOPMENTS, HEYES LANE,  
ALDERLEY EDGE,  
CHESHIRE SK9 7LF  
Tel: (01625) 598400. Fax: (01625) 598276

Location  
**SOVEREIGN COURT  
SIPSON ROAD**

Title  
**LEASE PLAN  
UNITS 3 & 4**

Scale 1:500 @ A3  
Checked  
Date 18.03.24

Drawing No. **436-LEG-8026**

SITE PLAN scale 1:500 @ A3